

Dubby Jr.

Left and Right Side Instructions

Version 1.0

SAFETY
1st



Disconnect machine from power source before making any adjustments.



Always wear proper ear protection when working with machinery.



Use caution when handling sharp objects (saw blades, router bits, drill bits and so on). Use protective gloves whenever possible.



Always wear proper eye protection when working with machinery and tools.



Always wear proper respiratory protection when working near airborne dust particles.

Please read and fully understand any and all safety materials that came with your power tools or machinery before operation. Always follow all safety guidelines set in place by the power tool or machine manufacturer.

⚠ ALWAYS USE CAUTION WITH POWER TOOLS

The warnings and these instructions do not completely represent the total amount of possible information available in regards to the tool's use, safety and technique. Always be diligent and seek out as many opportunities as possible to improve your skills, techniques and overall knowledge whenever possible.

Remove your table saw riving knife and guard before using the Dubby Jr.

You must re-install riving knife and guard once you are finished using the Dubby Jr.

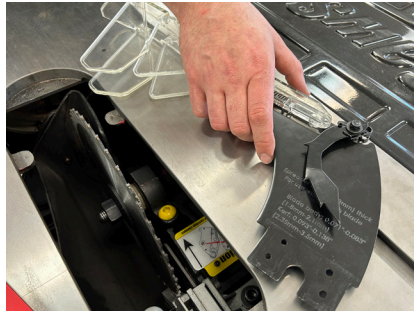

BEFORE USING THE Dubby Jr. :

- **DO NOT CUT** workpieces that are too small or narrow to be held on to.
- The Dubby Jr. must be completely assembled as detailed in these instructions before use.
- Turn the power off and lower the blade and proceed to become familiar with the cutting process by practicing the motion of the cut.

⚠ DO NOT RAISE
The saw blade
more than 2" in height
while operating the
Dubby Jr.



GENERAL SAFETY GUIDELINES

Follow all workshop safety practices, including:

- Keep all children and non-attentive bystanders away from the operating area at all times
- **NEVER** use power tools in flammable working environments. **DO NOT** use power tools in the presence of flammable liquids, fumes or dust particles
- **ALWAYS DISCONNECT** and **TURN OFF** all power tools **BEFORE** you make any adjustments.
- **ALWAYS BE ALERT** and use sound judgment when using this tool and power tools. Do not use this product or any power tool if you are impaired by medications, alcohol, drugs or fatigued in any way
- Make sure work area is well lit, clean and organized to reduce tripping or knocking over hazards
- Workshop attire means dress appropriately for workshop projects. Remove jewelry, tie up long hair and secure loose clothing before using the Dubby Jr.
- **WEAR PROPER** eye protection, hearing protection and respiratory nose and mouth protection that complies with **NIOSH/OSHA/ANSI** safety standards
- Use dust collectors, dust collection tools and accessories in combination with dust face masks to reduce extreme exposure to dust and dust particles
- When appropriate & whenever possible, use safety devices like push blocks, featherboards, push sticks etc.
- Always keep a large enough work area so you can maintain proper footing at all times and never overreach when using power tools
- **NEVER** force woodworking tools to do anything

LEFT Side Dubby Jr.

PARTS

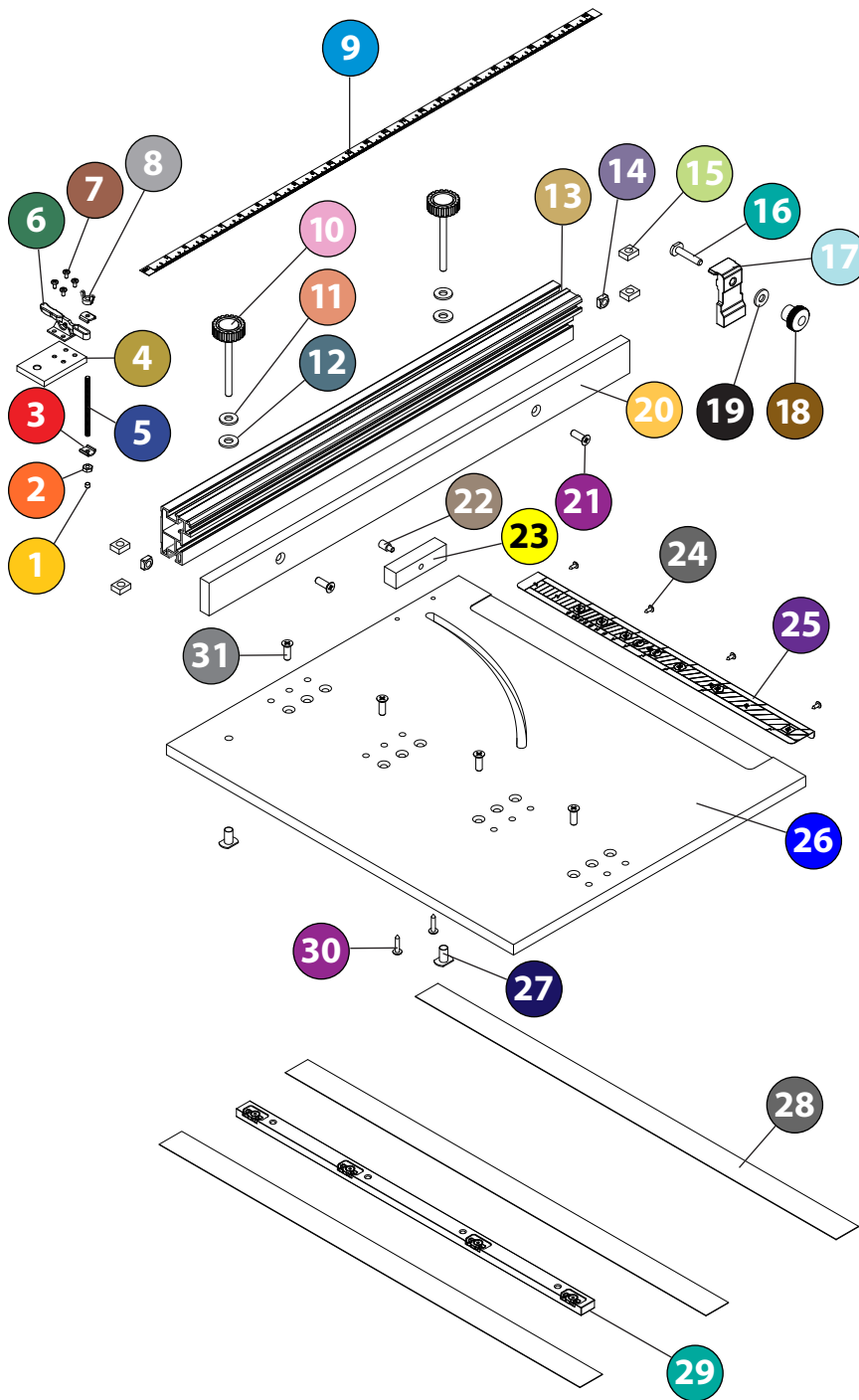

NO	QTY	Description
1	1	Toggle Cap
2	1	Toggle Nut
3	2	Flanged Washer
4	1	Toggle Mounting Plate
5	1	Threaded Rod
6	1	Toggle Body
7	4	Toggle Mounting Screws
8	1	Toggle Wing Nut
9	1	Left Measuring Tape
10	2	Studded Knob
11	2	Steel Washer
12	2	Nylon Washer
13	1	Aluminum Fence
14	2	Small Square Nut
15	4	Nylon Glide Block
16	1	T-Bolt for Stop Block
17	1	Stop Block
18	1	Stop Block Knob
19	1	Stop Block Washer
20	1	MDF Sub Fence
21	2	Sub Fence Screw
22	1	Positive Stop Pin
23	1	Wooden Positive Stop
24	4	Short Screw for Scale
25	1	Left Platform Scale
26	1	Left Side MDF Platform
27	2	Recessed T-Nut
28	3	Mylar Sticky Back Strip
29	1	NoPlay Miter Bar
30	2	Screw for Positive Stop
31	4	Screw for Miter Bar

Please Note:

These instructions and photographs are showing the assembly and basic use of the left side Dubby Jr.

RIGHT Side Dubby Jr.

PARTS

NO	QTY	Description
1	1	Toggle Cap
2	1	Toggle Nut
3	2	Flanged Washer
4	1	Toggle Mounting Plate
5	1	Threaded Rod
6	1	Toggle Body
7	4	Toggle Mounting Screws
8	1	Toggle Wing Nut
9R	1	Right Measuring Tape
10	2	Studded Knob
11	2	Steel Washer
12	2	Nylon Washer
13	1	Aluminum Fence
14	2	Small Square Nut
15	4	Nylon Glide Block
16	1	T-Bolt for Stop Block
17	1	Stop Block
18	1	Stop Block Knob
19	1	Stop Block Washer
20	1	MDF Sub Fence
21	2	Sub Fence Screw
22	1	Positive Stop Pin
23	1	Wooden Positive Stop
24	4	Short Screw for Scale
25R	1	Right Platform Scale
26R	1	Right Side MDF Platform
27	2	Recessed T-Nut
28	3	Mylar Sticky Back Strip
29	1	NoPlay Miter Bar
30	2	Screw for Positive Stop
31	4	Screw for Miter Bar

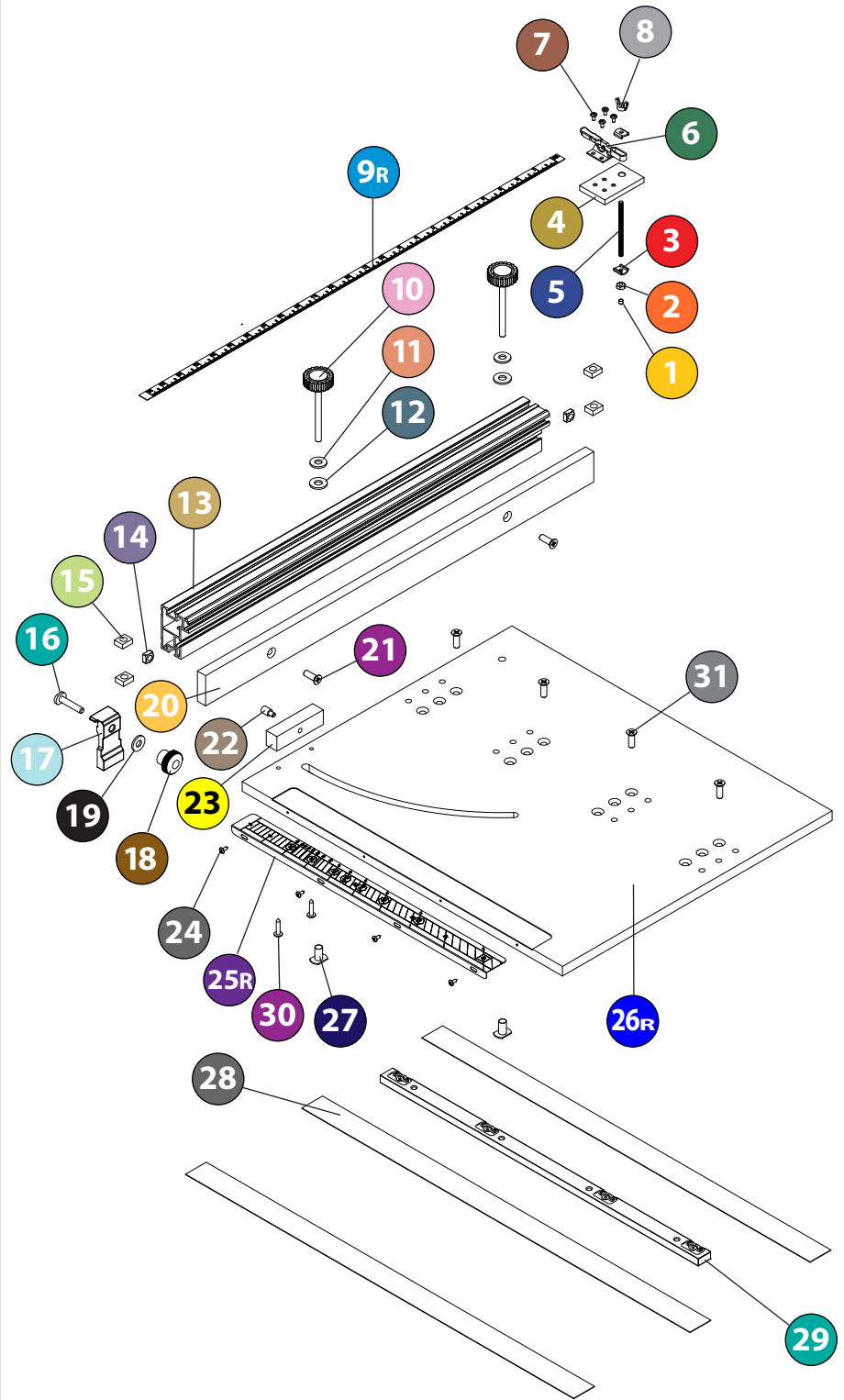

Please Note:

For the Right side Dubby Jr. follow these instructions. Keep in mind the difference from what is shown will be that the assembly and basic use will be performed on the opposite side.

Adjust and Install the NoPlay™ Miter Bar

Adjust the Expandable Glides for a NoPlay™ fit

⚠ CAUTION:

When adjusting the Expandable Glides do not over tighten them. Doing so will prevent the miter bar from sliding smoothly and could possibly damage the Expandable Glides.



Rotate Clockwise
To tighten your miter bar fit in the slot

Patent Pending

Rotate Counter Clockwise
To loosen the fit of your miter bar in the slot

Shop Tip:

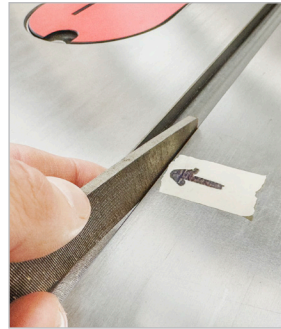

Pinching or binding is often caused by the miter slot slightly varying in width. To find the pinch/bind location, loosen all but ONE of the Expandable Glides and slide the bar the full length of the slot. Mark the trouble spots with tape or a marker and lightly file or sand the slot as needed.

Left Side Dubby Jr.

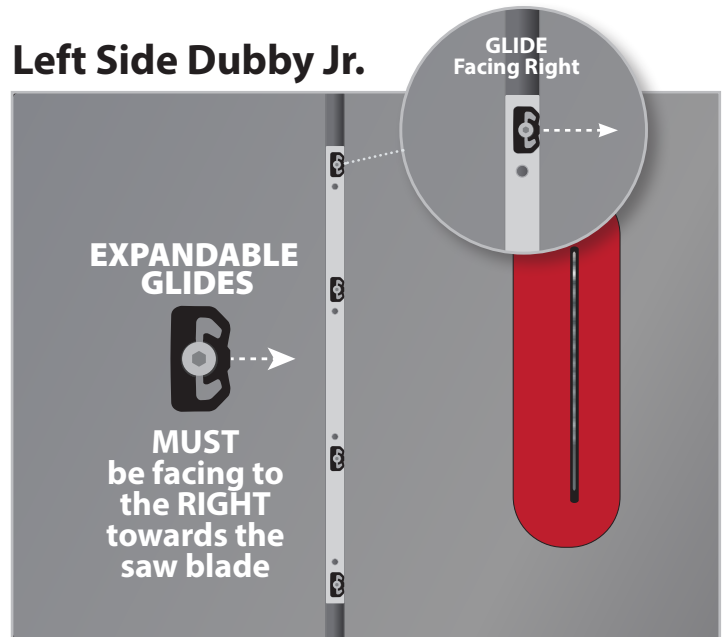

Before mounting



Place the NoPlay miter bar in the table saw miter slot, with the expandable glides facing up as shown here. Adjust the miter bar in your table saw miter slot prior to mounting on to your Dubby Jr. platform base. Slide the bar in the slot front to back. Adjust the expandable glides as needed for a smooth run.

Right Side Dubby Jr.

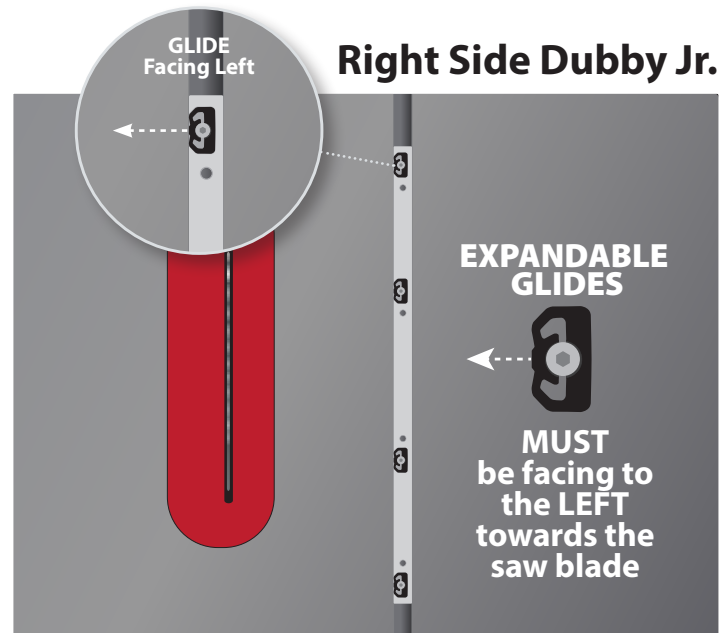

Attach the NoPlay Miter Bar On to the Dubby Jr. Platform

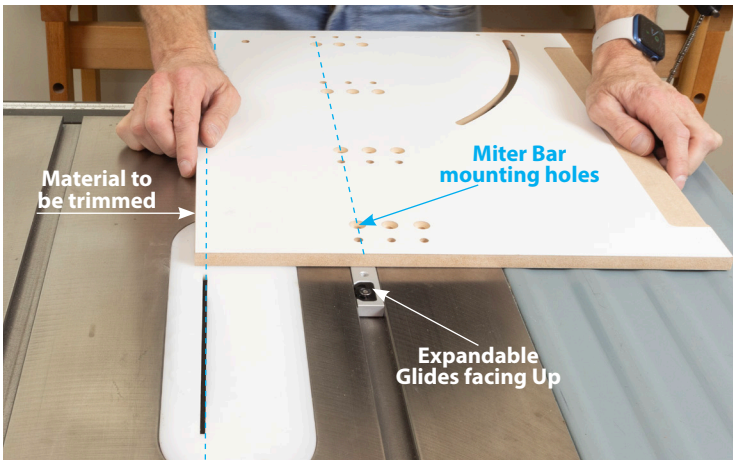

With the NoPlay miter bar in your table saw slot, place the Dubby Jr. Platform on top of the NoPlay miter bar. Align the platform miter bar mounting holes with the threaded holes on the NoPlay miter bar.

There are 3 sets of holes, choose the set of holes that will allow you to trim off the **LEAST** amount of MDF platform material as possible.

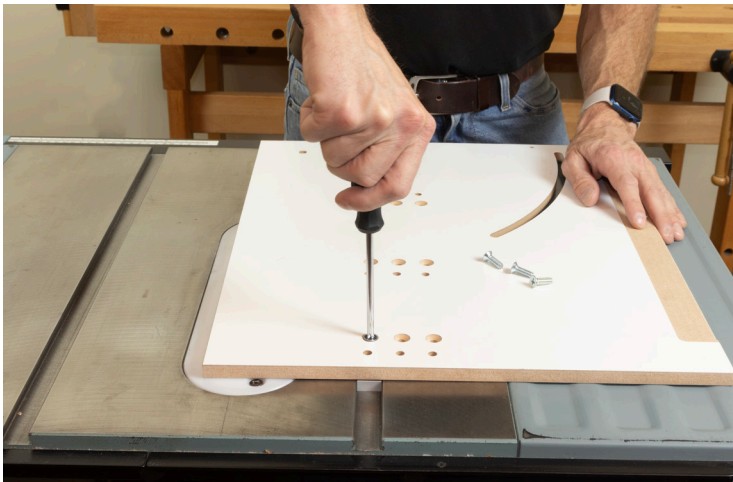

Once aligned, secure the MDF platform to the NoPlay miter bar with the supplied machine screws.

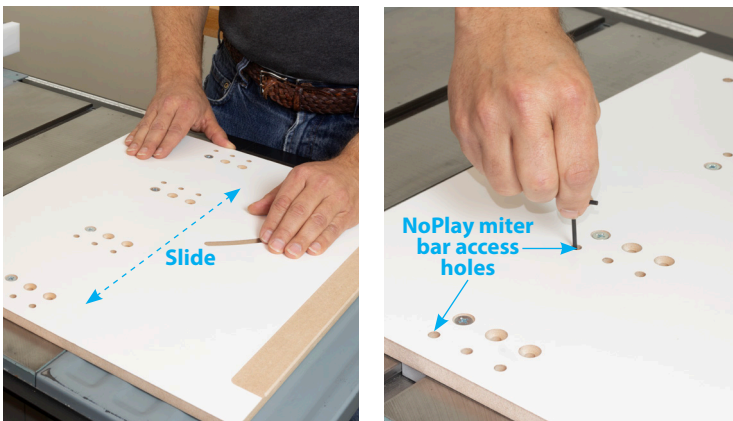

Slide the MDF platform forward and backward a few times. If it does not slide smoothly, adjust the expandable glides using the supplied hex key wrench through the NoPlay miter bar access holes as shown above.

Trim the Platform to Size

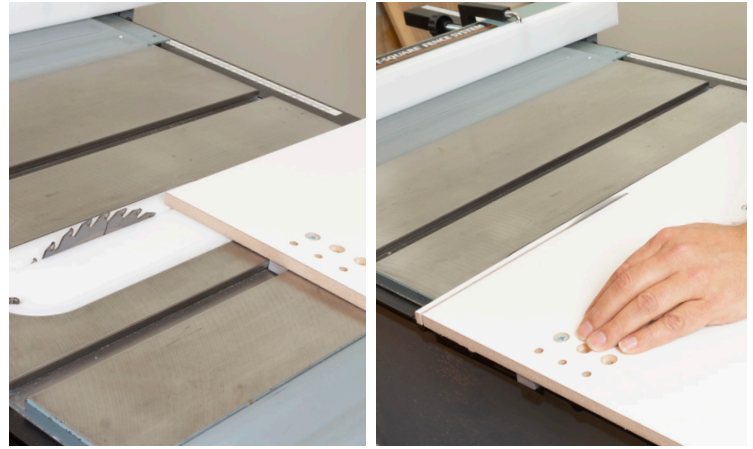

With the MDF platform and NoPlay miter bar adjusted, slide the platform in front of the saw blade so that it is not contacting the blade. Turn the table saw on and slowly trim off the excess material on the MDF platform as shown above.

Install Mylar Strips

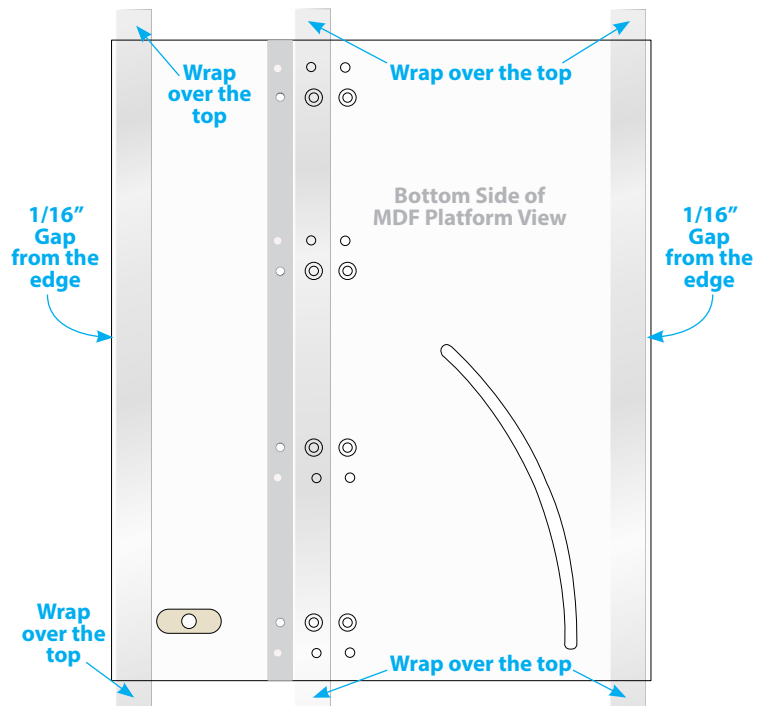

Once the MDF platform is cut to size, power off the saw and lower the blade. Flip the platform to expose the bottom and lay it on your saw. Clean any dust or debris off the bottom of the MDF platform. Apply mylar strips in the positions shown above. Leave appx. 1/16" of space on both outside edges.

WRAP MYLAR STRIP OVER THE TOP

Leave enough length at each end to wrap the tape over the top as shown.

This will prevent the mylar tape from "rolling under" the MDF platform after repeated use.

Mylar Sticky Back Strip

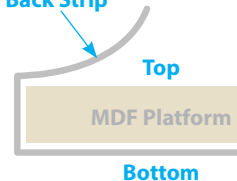

Install Scale

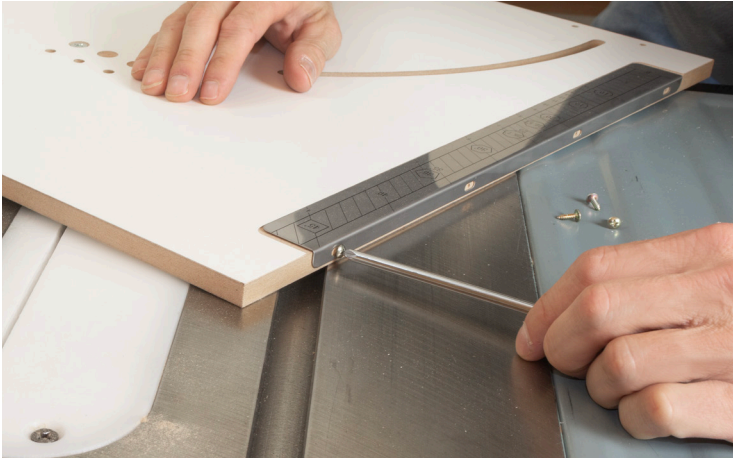

Using the four supplied short wood screws, install the scale as shown above. The holes for mounting the scale are pre-drilled. Do NOT completely tighten the screws as we will be calibrating the scale to the fence later in these instructions.



Once the nylon glide blocks have been inserted, align the top and bottom glide blocks with the holes on the aluminum fence as shown above.

Install Fence Positive Stop



Using the two supplied wood screws, install the wooden positive stop on to the platform as shown above. Make sure the positive stop pin opening is facing the back of the platform as shown above.

How the Knob to Fence Assembly Should Look

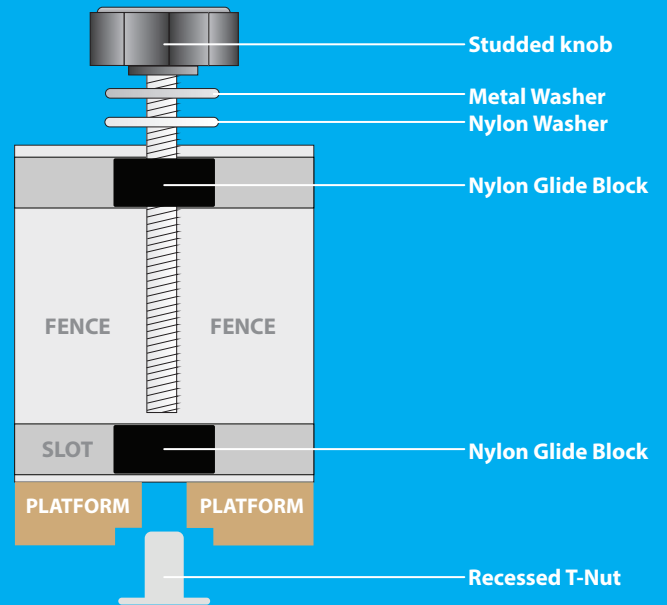

Assemble Fence Components

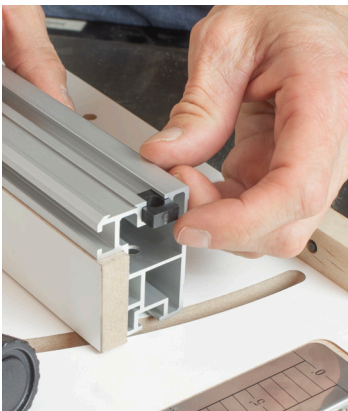

Insert four nylon glide blocks into the top and bottom track of the fence as shown above. The nylon blocks should slide smoothly in the track.

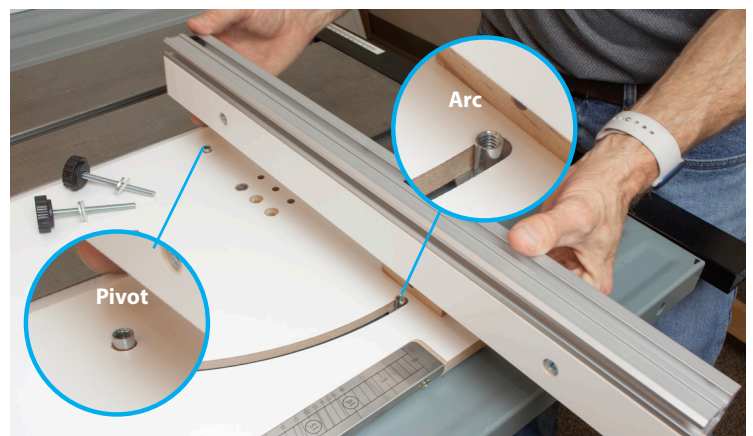

Insert the two Recessed T-Nuts from the underside of the platform. One goes into the pivot hole and the other goes into the arc slot as shown above. The recessed t-nuts should protrude through the top side of the platform as shown.

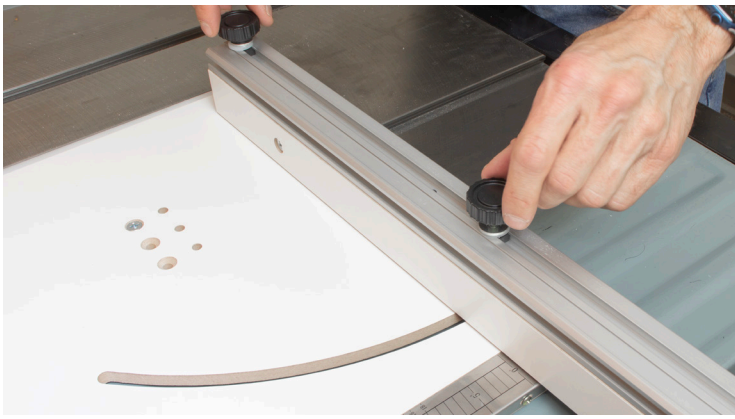

Place the aluminum fence on top of the MDF platform aligning the nylon glide blocks and holes with the recessed T-nuts. If needed, adjust the glide blocks to properly align with the recessed t-nuts. With the fence assembly properly aligned, insert the studded knobs with metal washer and nylon washer through the fence hole and into the recessed t-nuts. Secure the fence with the studded knobs as shown below.

ASSEMBLED

Once assembled, make sure the recessed t-nuts are up and inside the nylon glide blocks as shown here.

The recessed t-nuts must be fully seated into the MDF platform in order for the fence to operate smoothly and accurately.

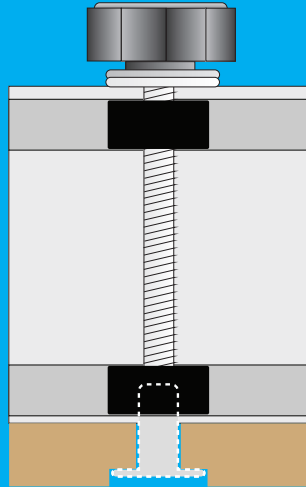

Square the Fence to the Platform

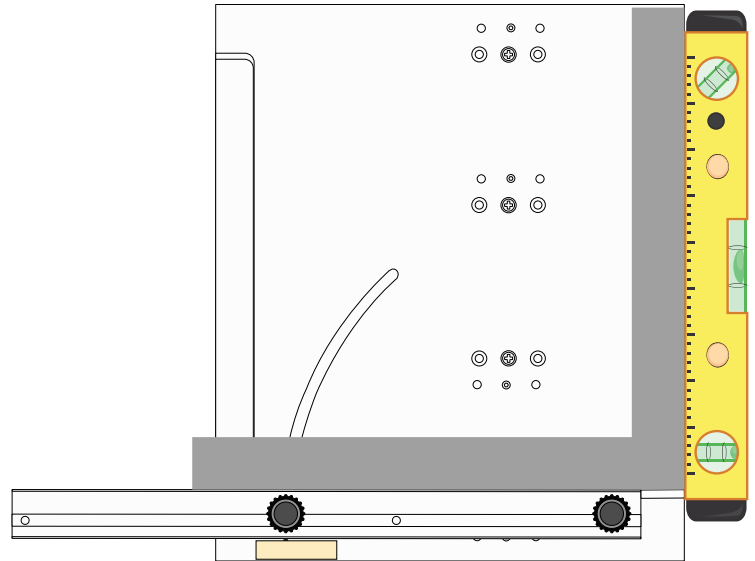

Loosen both fence Knobs. Place a straight edge against the cut edge of the platform. Using a square as your guide, pivot the fence by adjusting the arc end until it is seated at a 90 degree angle to the straight edge as shown above.

Don't Forget...

These instructions and photographs are showing the assembly and basic use of the Left side Dubby Jr.

For the Right side Dubby Jr. follow these instructions. Keep in mind the difference from what is shown, will be the assembly and basic use will be performed on the opposite side.



Once set at the 90 degree angle, hold the square and fence in place and tighten the arc knob first. Once the arc knob is secure, tighten the pivot knob. The fence is now locked at 90 degrees.

Adjust/Calibrate the Scale

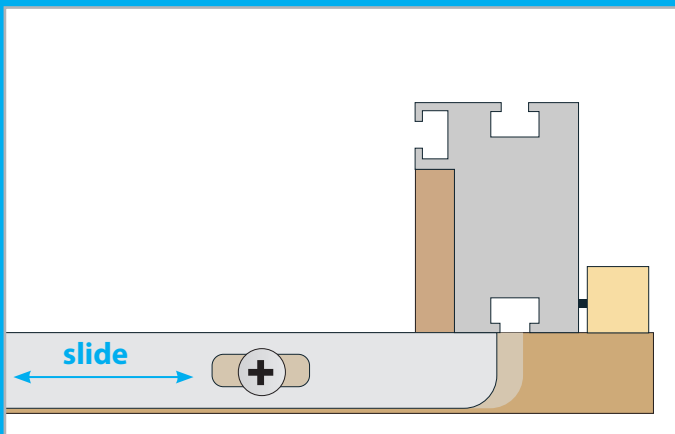

With the fence locked at 90 degrees and the platform scale screws loose, slide the scale (front or back) to position the "zero" (0) line so the line just touches the MDF sub fence face, as shown in the illustration below. When you tighten the screws, be sure to not over tighten them, as this can cause the scale to shift/deform out of alignment.

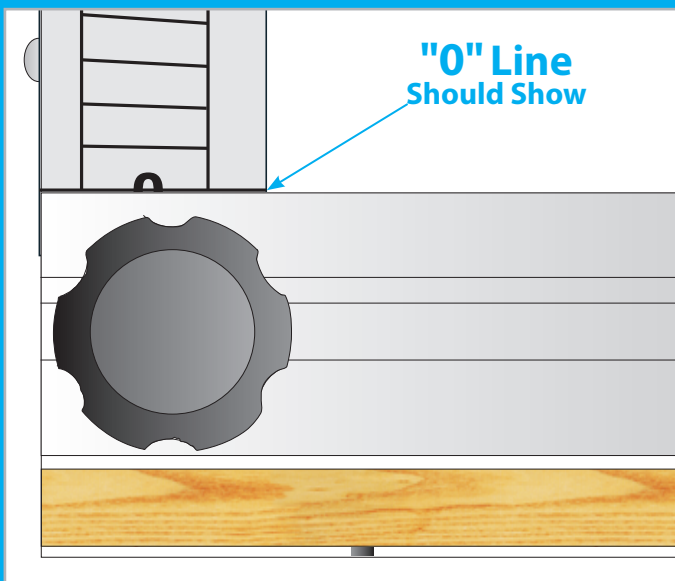

Set Positive Stop Screw

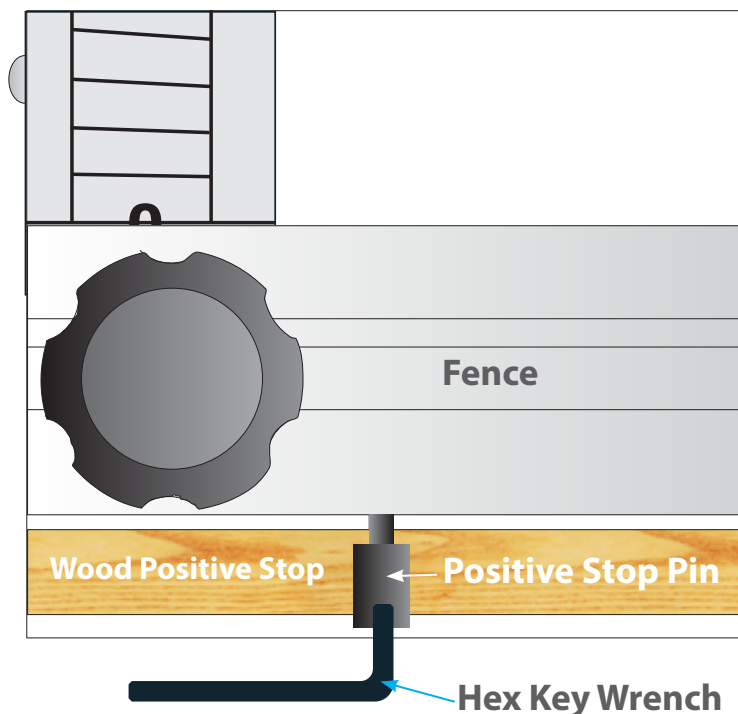
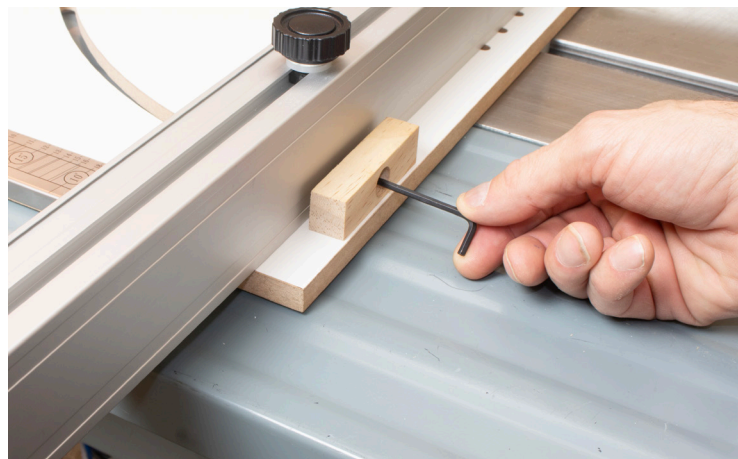

Once the fence and scale are calibrated and the fence is secured with both knobs tightened, adjust the positive stop pin in the wood positive stop. Rotate the positive stop pin clockwise until the tip of the positive stop pin just touches the back of the fence.

Install Measuring Tape

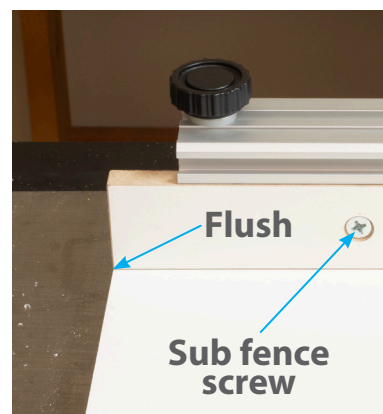

Loosen the MDF sub fence screws and slide the sub fence to the cut edge of the platform until it is flush with the edge. Once flush, tighten the MDF sub fence screws.



Measure in 2" from the cut edge of the MDF sub fence and make a mark on the MDF sub fence. Carry that mark to the top of the Aluminum fence.



Slide the measuring tape into the shallow slot on the top side of the aluminum fence as shown above.



Align the 2" mark on the tape with the 2" mark you made on the aluminum fence as shown above. Installing the tape without permanently affixing it allows you to re-calibrate the MDF sub fence and the measuring tape each time you change the angle of the cut.

Please Note:

The tape is PSA (sticky back) and can be permanently affixed to the aluminum fence if so desired.

Install Toggle Hold Down Assembly and Material Stop Block

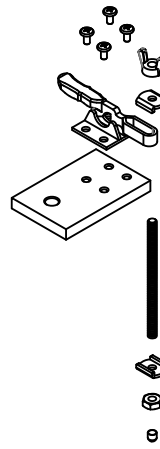

Toggle Assembly

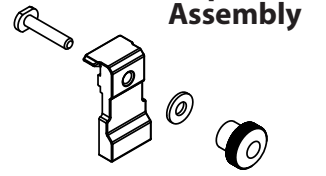

Stop Block Assembly

Assemble the toggle and toggle mounting plate. Use this exploded view drawing as a reference.

Remove the pivot knob, metal washer and nylon washer from the aluminum fence.

Place the toggle assembly on to the fence and align the hole on the toggle base plate with the hole for the pivot knob.

Once aligned, secure the toggle assembly to the aluminum fence using the pivot knob as shown below.

Using the above exploded view as a reference, assemble the stop block. Once assembled, slide the stop into the front t-slot on the fence and secure it in place.



Pivot Knob

**Your Dubby Jr.
is Ready to Cut with Precision!**

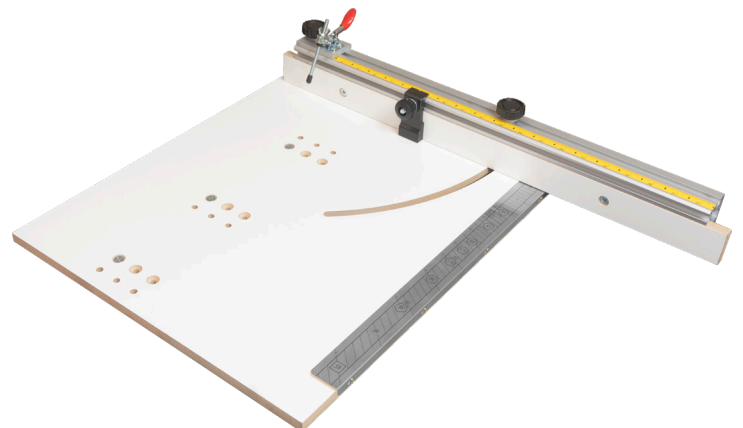

The anatomy of The Dubby™ Jr. Scale

The most popular degrees are displayed inside the shapes to represent the desired cut angle of the fence

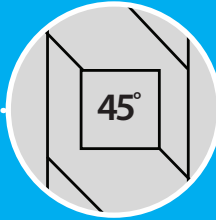

The shapes on the scale provide a visual of your project

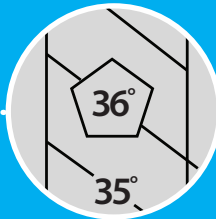

The numbers on the inside edge of the scale denote the number of sides to be cut.

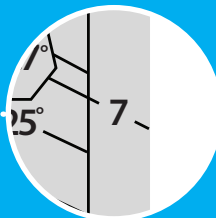

Commonly used angles will not have a shape around them

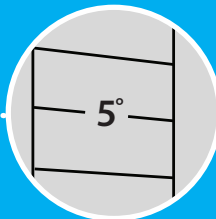

Cutting a Multi-Sided Frame

In this example we will be cutting a 5 sided frame.

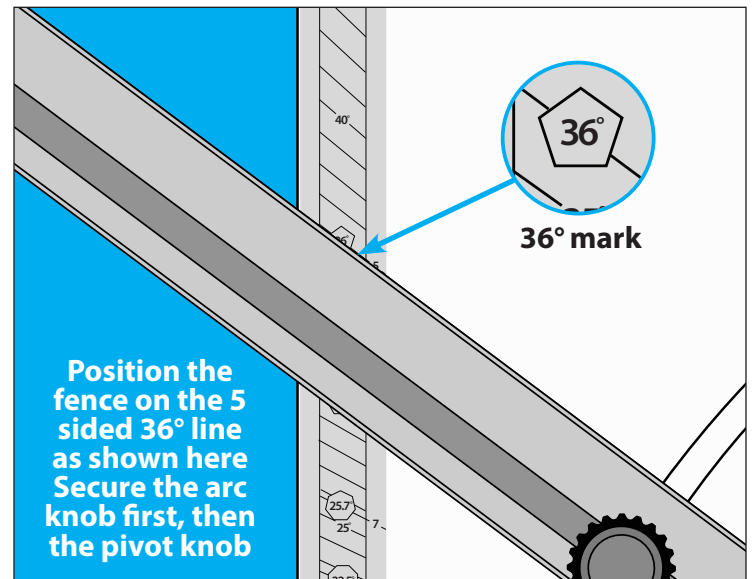
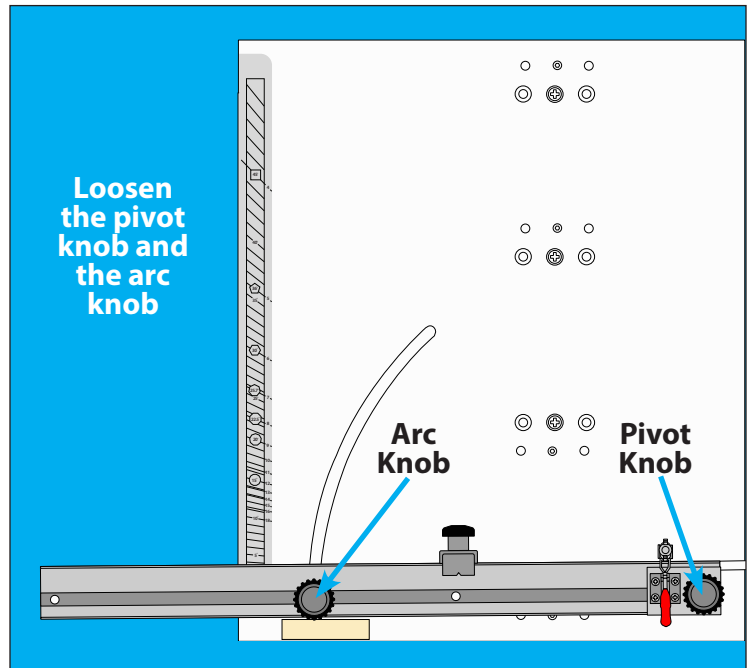

Loosen the sub fence screws and adjust the MDF sub fence so the it is flush with the cut edge of the MDF platform as shown here. Once flush, secure the MDF sub fence screws.

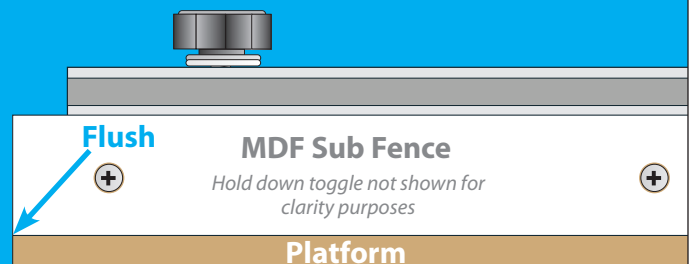

Please Note:
When changing the angle of the fence, make sure you reset the MDF sub-fence to be flush with the cut edge of the platform.



Before starting this example we set the Dubby Jr. at 90 degrees and pre-cut 5 pieces of picture frame stock to the exact same length as shown above.



As shown in the image above, place the mitered side of the workpiece against the stop block. Secure the workpiece with the hold down toggle. Turn on table saw and slowly feed the stock through the blade. Repeat this process for the remaining 4 pieces.

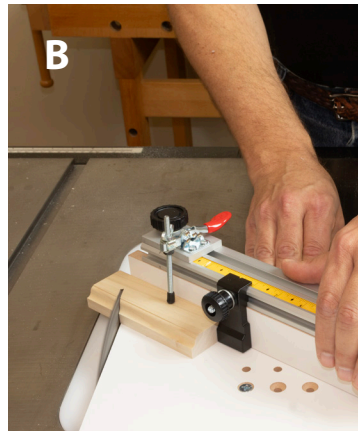
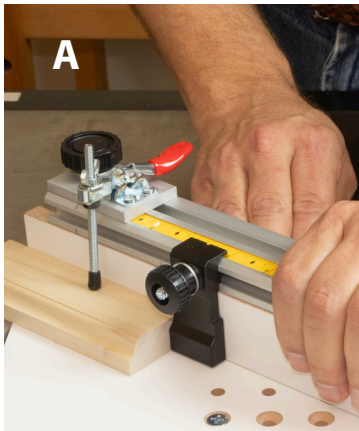

Set and secure the stop block to the desired cut length, slide the workpiece up against the stop block (**A**). Secure the workpiece with the hold down toggle. Turn on table saw and slowly feed the stock through the blade (**B**). Repeat this process for the remaining 4 pieces.



After the 5 pieces have been cut, power off table saw. You should now have 5 pieces with precisely cut angles on both ends as shown above.



After the 5 pieces have been cut, power off table saw. The 5 pieces should resemble the image above.



Once cut and assembled, the 5 pieces should form a perfect pentagon shape as shown here.

Dubby™ Jr.

a new take on a great idea!

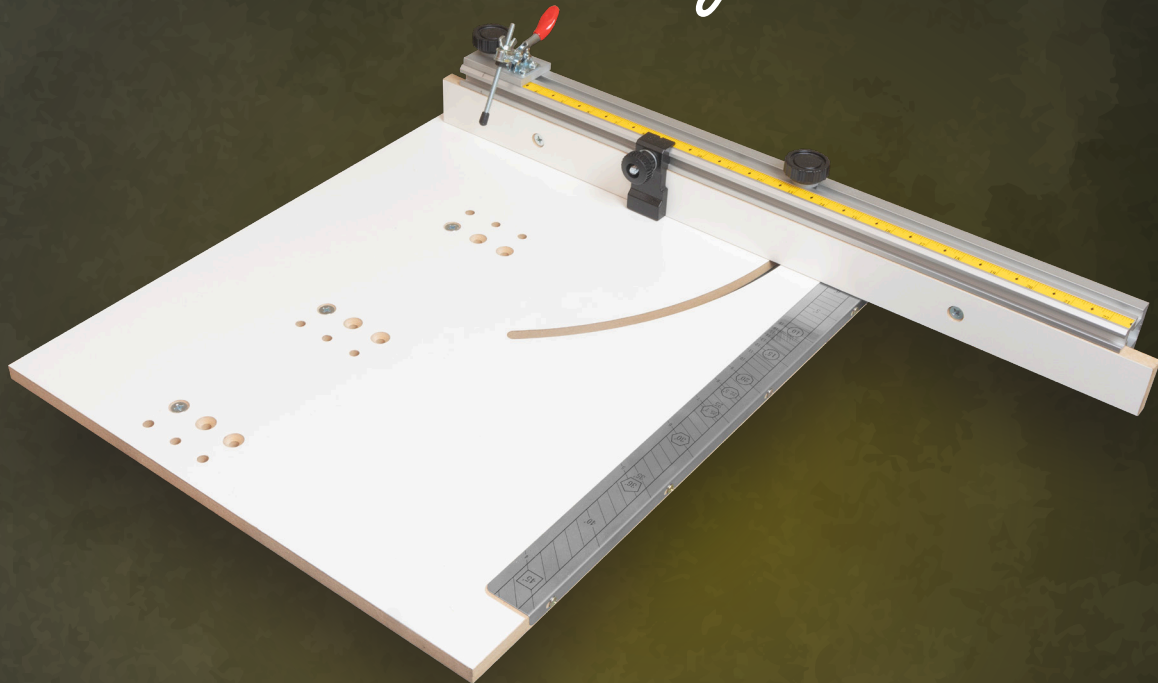

*Missing
Parts?*

Questions?

Thank you for choosing the Dubby Jr. We highly value our customers and we always do our best and strive to make sure that you are satisfied with your buying experience with us.

We have put a great deal of effort into packing and shipping high quality tools and accessories and hope that the products you purchase from us either meet or exceeds your expectations.

If for any reason you have an issue or are in need of parts from your Dubby Jr. order, please don't hesitate to contact us at 1-888-512-9069. We will do our absolute best to make it right.

For more info...

Scan this code

with your mobile phone or tablet

